

AERO

AEROVITAL ambience smart DM

Ventilation unit with sound absorption for installation under the ceiling.

Window systems

Door systems

Comfort systems

Contents

1	TARGET GROUP OF THIS DOCUMENTATION.....	3
2	INTENDED USE	3
3	SAFETY NOTES	3
4	GENERAL NOTES.....	3
5	SCOPE OF DELIVERY	4
5.1	AEROVITAL ambience smart DM	4
5.2	Assembly set for ceiling installation.....	4
6	ASSEMBLY.....	5
6.1	Installation requirements.....	5
6.2	Additional requirements for AEROVITAL ambience smart.....	5
6.3	Installation dimensions	5
6.4	Installation sequence	5
7	TECHNICAL SPECIFICATIONS.....	14

1 Target group of this documentation

- This documentation is intended for use by specialists.
- All instructions concerning assembly, installation and repairs described in this document are to be performed exclusively by experienced professionals with training and practice in the installation, commissioning, servicing and maintenance of decentralised ventilation units.

2 Intended use

- The installation of the assembly set must be performed by two persons.
- Do not use the AEROVITAL ambience in environments with corrosive or explosive atmospheres (dust, vapour or gas).
- The assembly set must always be installed by experienced specialists, in accordance with the installation and planning documents of SIEGENIA. The installation information in these instructions must be complied with at all times.
- The assembly set may only be mounted in a suitable ceiling construction. This must be verified by a structural engineer if necessary.
- Use the unit only with original accessories from SIEGENIA.
- Comply with the safety regulations for operating electrical equipment and, if necessary, for ladders, steps and work overhead or at certain heights.
- Use the assembly set only when it is in a technically sound condition.
- Do not modify the components in any way.

3 Safety notes

- To prevent **personal injury or damage to property**, always comply with the following instructions
 - If any work is required for the connection of the device to the 230 V AC mains power supply, this may only be carried out by an electrician.
 - All-pole safety isolation is required if the customer is routing the mains cable.
 - The current VDE directives must be observed.
 - Relevant country-specific regulations with regard to installation, functional testing, repair and maintenance of electrical products must be strictly followed for all work carried out on the voltage supply system or house wiring system.
- **Risk of poisoning from combustion fumes**
A vacuum can be created when this ventilation unit is operated simultaneously with a heat-producing appliance (such as a stove or gas heater). The vacuum could cause exhaust fumes to enter the room, leading to the danger of poisoning.
 - Have the ventilation compound in your home checked by an accredited chimney sweep.
 - For ventilation units that permanently run in exhaust air operation, install a safety device in consultation with the accredited chimney sweep.

4 General notes

All the dimensions in this documentation are specified in millimetres (mm).

5 Scope of delivery

5.1 AEROVITAL ambience smart DM

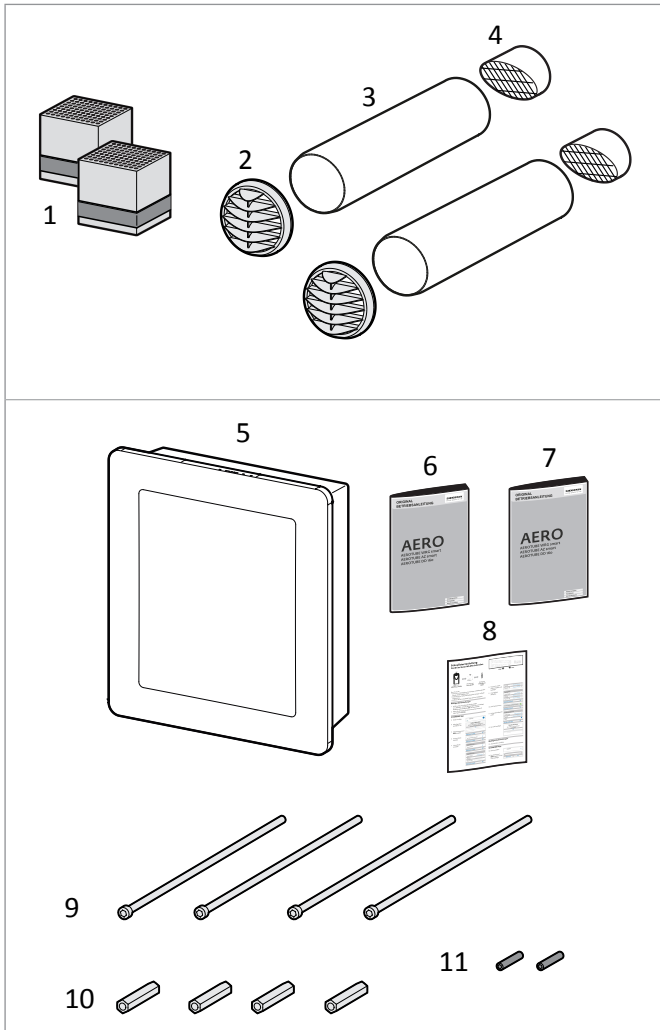

Item	Name	Quantity
1	Storage stone	2
2	Weather grille	2
3	Pipe	2
4	Insect screen	2
5	AEROVITAL ambience	1
6	Assembly instructions	1
7	Original operating instructions	1
8	Quick start instructions	1
9	Cheese head screw M6 x 250	1
10	Distance sleeve M6 x 50	4
11	Grub screw M4 x 20	2

5.2 Assembly set for ceiling installation

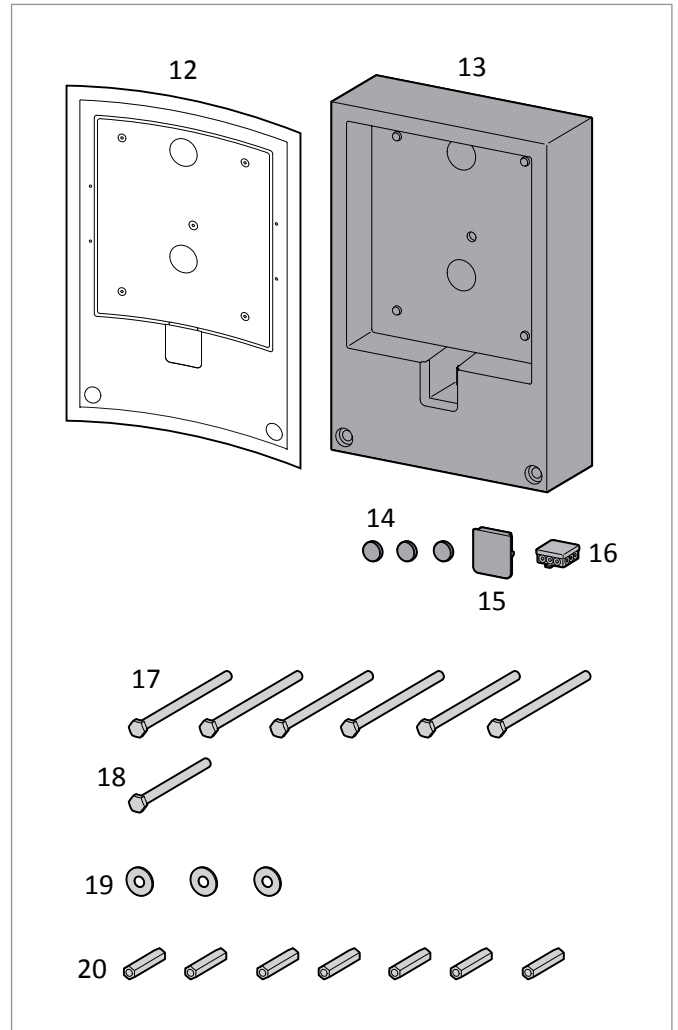

Item	Name	Quantity
12	Drilling template	1
13	Assembly case	1
14	Plug fixing hole	3
15	Cover electrical connection	1
16	Cable junction box	1
17	Hexagon screw M6 x 90	6
18	Hexagon screw M6 x 70	1
19	U-washer M8	3
20	Distance sleeve M6 x 50	7

6 Assembly

6.1 Installation requirements

⚠ ATTENTION

Concealed cables and pipes

Risk of damage to property by drilling holes through concealed cables or pipes!

- Before installing the unit, use a suitable cable and pipe detector at the installation location to identify the presence of concealed cables or pipes in the wall (such as water pipes).

- Suitable installation position:
 - in the vicinity of a 230 V AC power connection (unit's maximum cable length: 4.5 m)
 - When a permanent mains connection is used: over a flush-mounted box
 - not in the immediate vicinity of radiator thermostats

6.2 Additional requirements for AEROVITAL ambience smart

- The AEROVITAL ambience smart should be installed to be as free from interference as possible.
- The following interferences can have a negative influence on the WLAN signal:
 - water pipes
 - stone and concrete walls
 - metal objects
 - air conditioning units
 - wireless devices (e. g. radio telephones, baby monitors, Bluetooth loudspeakers, etc.)
 - WIFI networks on the same wireless channels (e. g. the neighbour's WIFI router)
- If energy-carrying cables are routed in parallel to data cables (ISDN, DSL, etc.), this could lead to interference e.g. in the speed of the data transmission

6.3 Installation dimensions

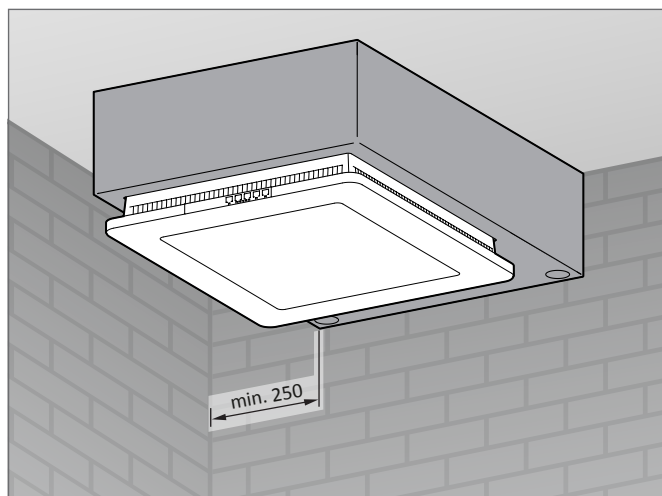

6.4 Installation sequence

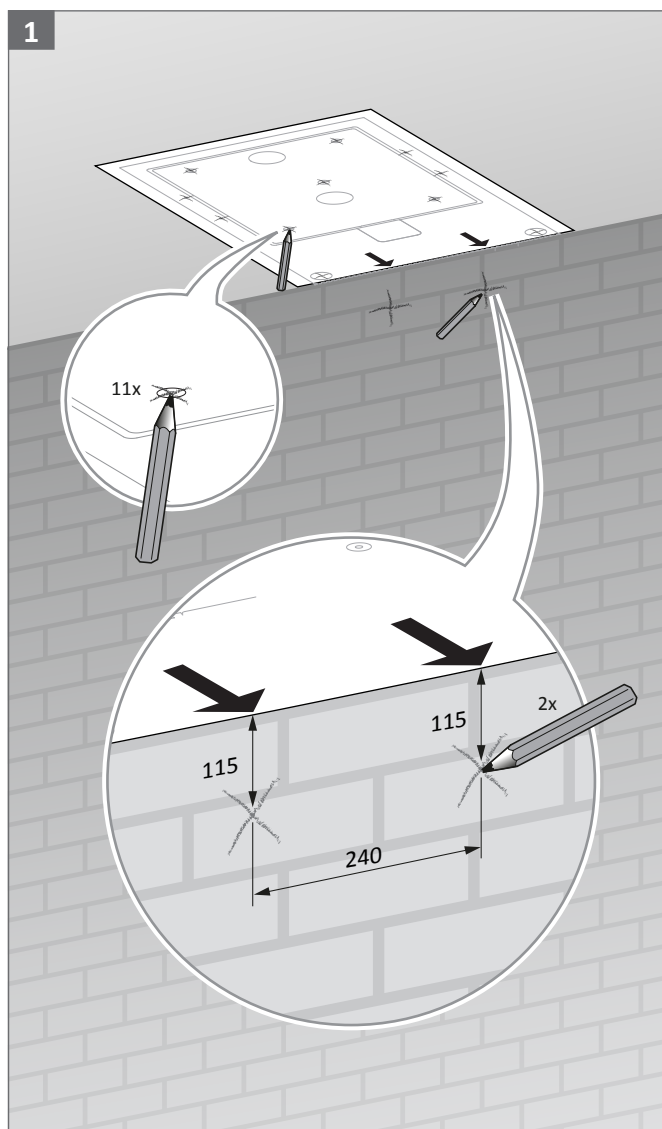

Mark the core holes and the fixing holes

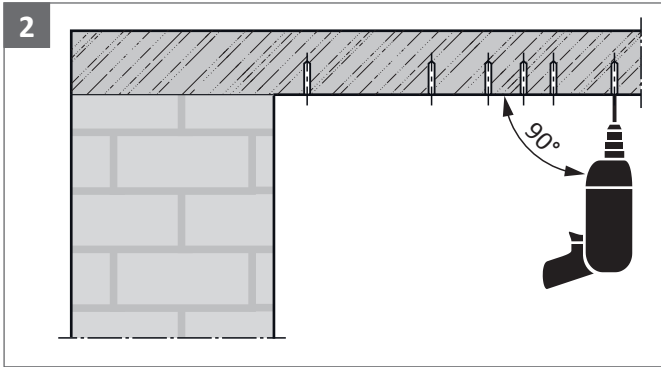

Drilling the fixing holes

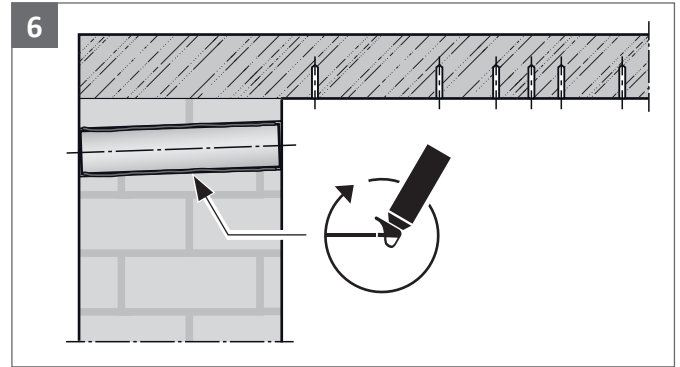

Insulate the pipes (depending on requirements)

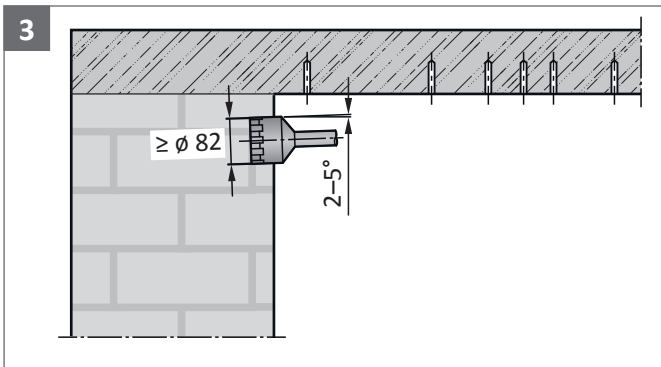

Drill the core holes

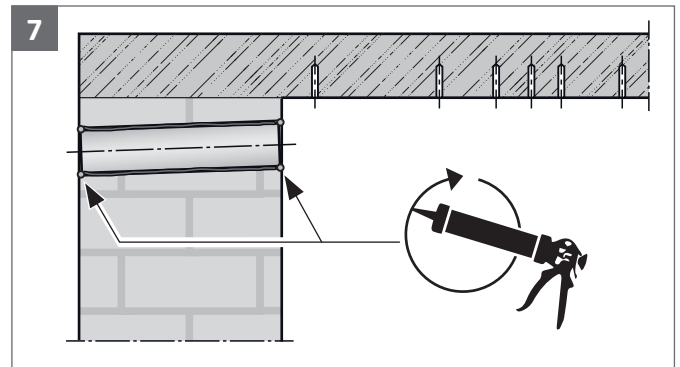

Seal the pipes

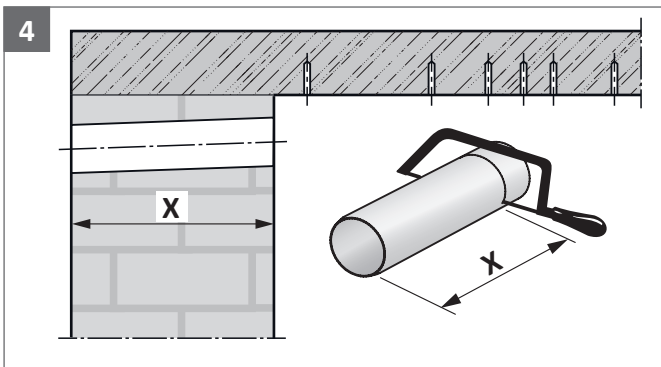

Shorten the pipes

! inside = airtight seal
outside = free-air seal

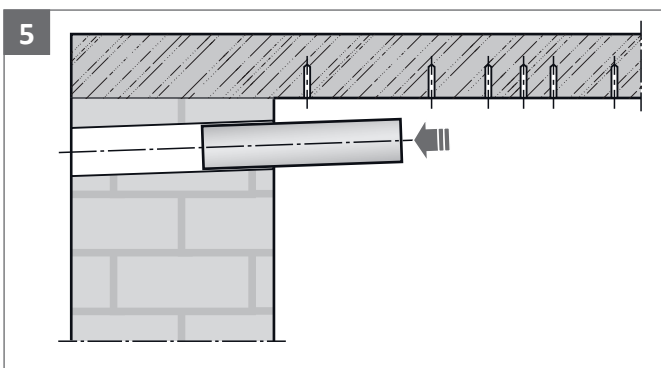

Insert the pipes

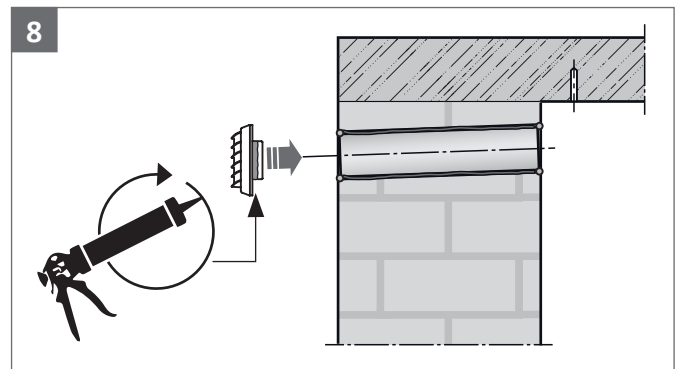

Insulate and fit the weather grille

! The lamellae on the weather grille must point downwards.

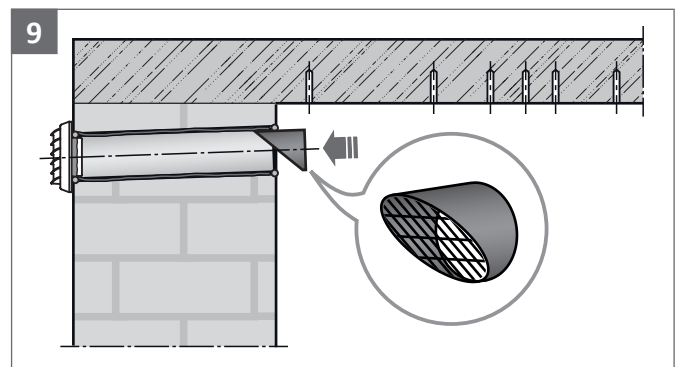

Insert the insect screen

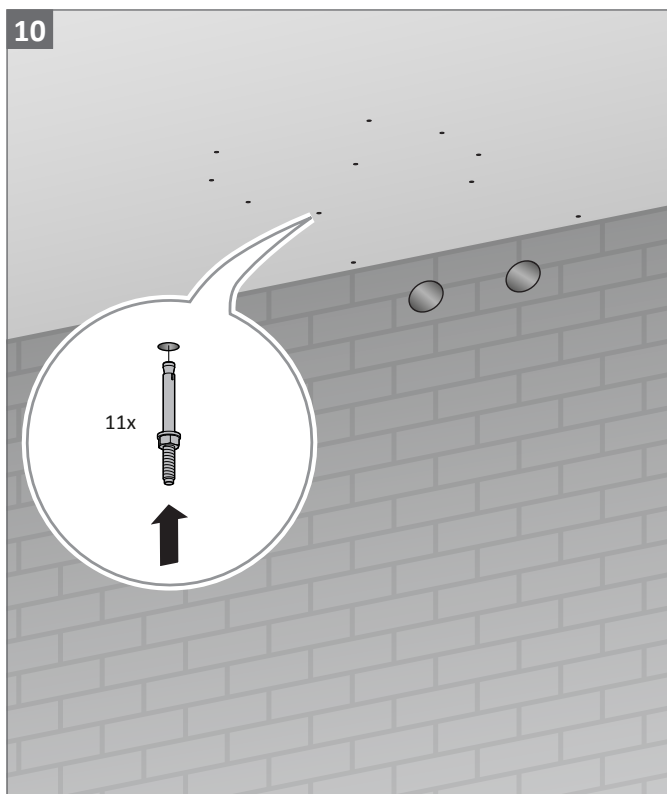

Fixing bolt anchor/hanger bolts in the ceiling



Suitable fixing material must be selected according to the composition of the ceiling and provided by the customer.

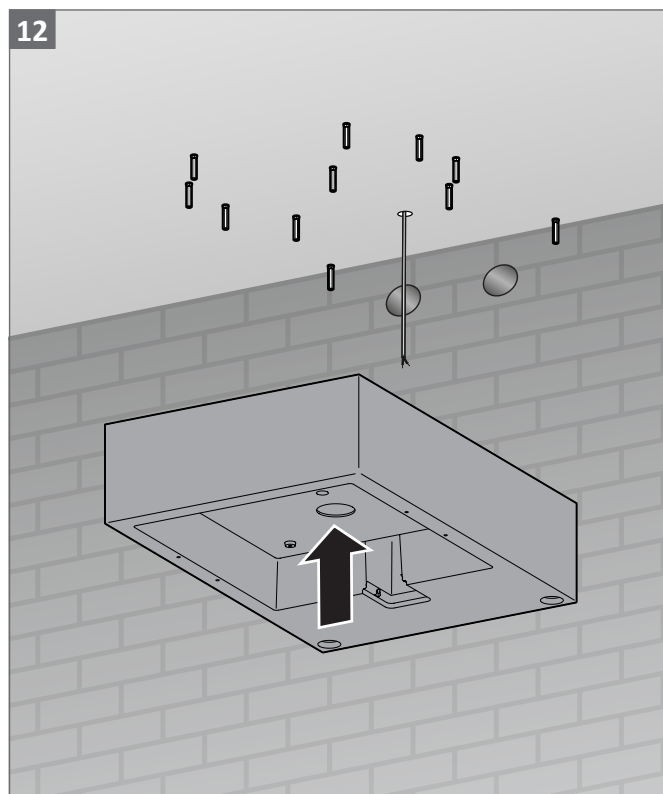

Position the assembly case under the ceiling

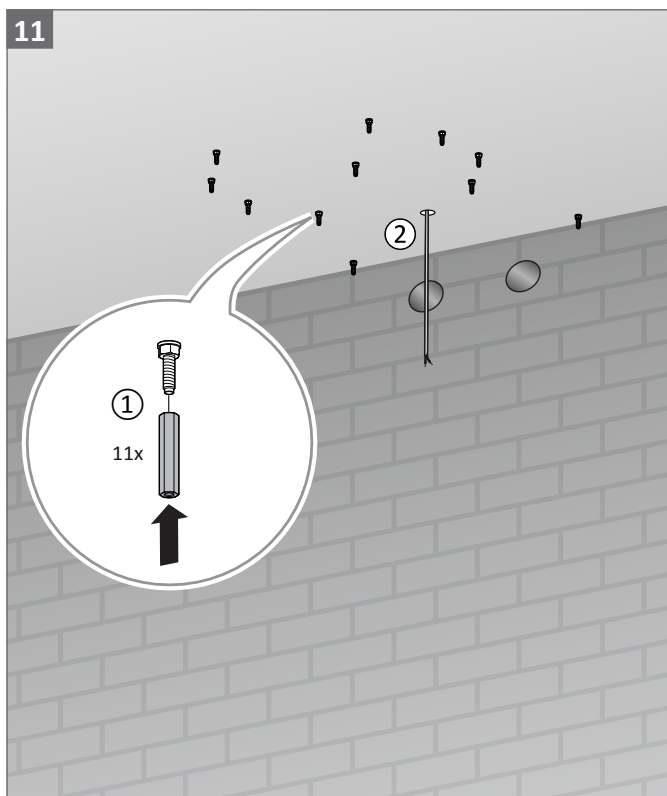

Turn distance sleeves on bolt anchors/hanger screws
Route cable

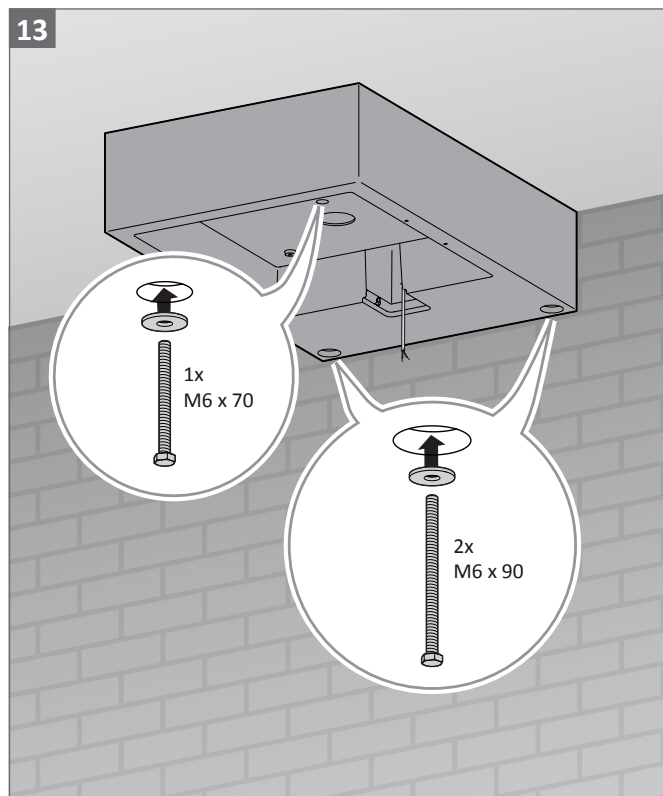

Insert washers and fix assembly case using hexagon screws.

14

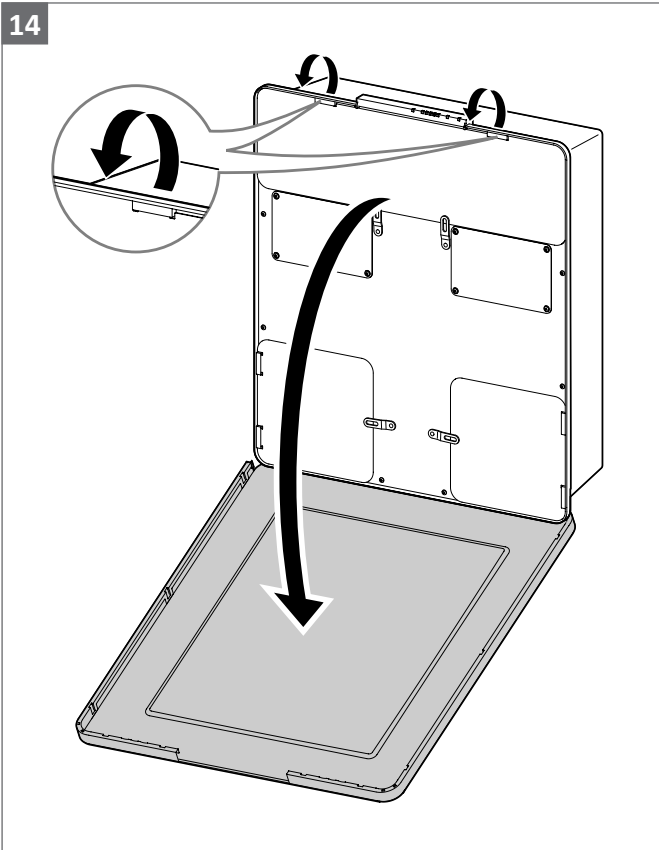

Open and remove the casing cover

16

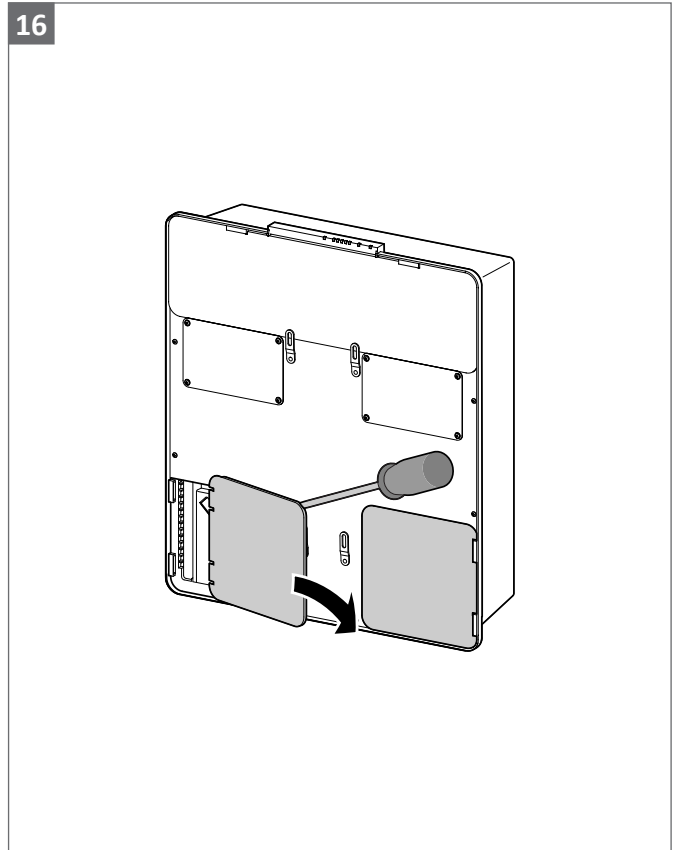

Release and remove the bottom cover plate

15

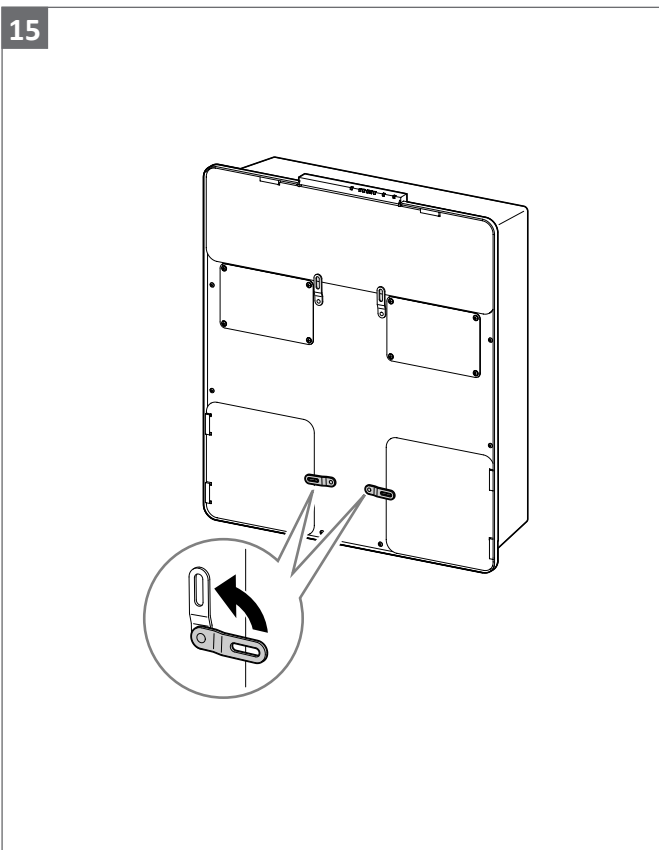

Release the fixing brackets of the bottom cover plate

17

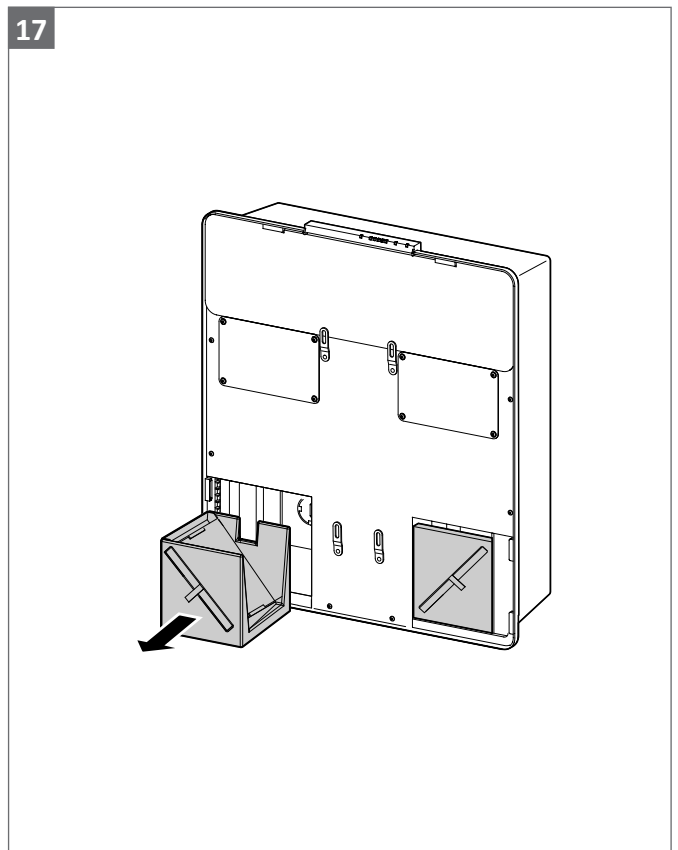

Remove the exhaust air filter and filter bracket
(left and right)

18

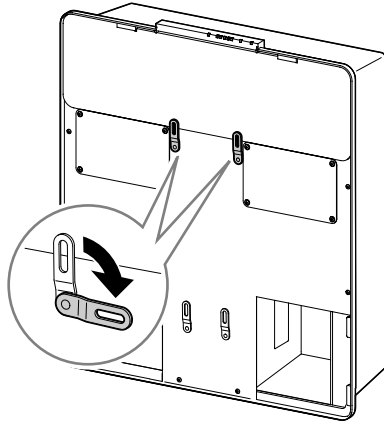

Release the fixing brackets of the top cover plate

20

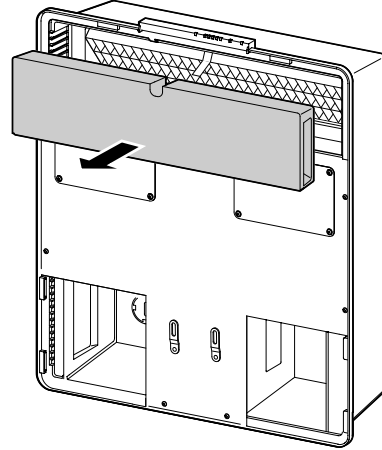

Remove the supply air filter

19

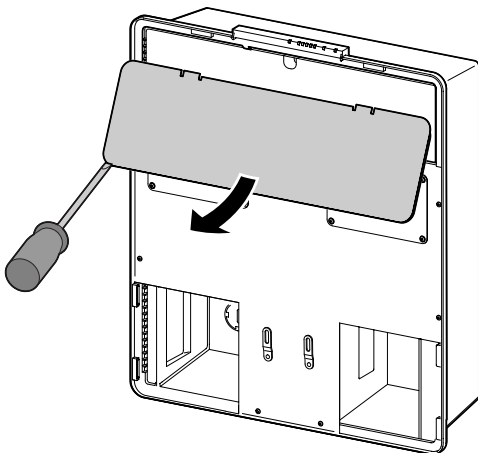

Release and remove the top cover plate

21

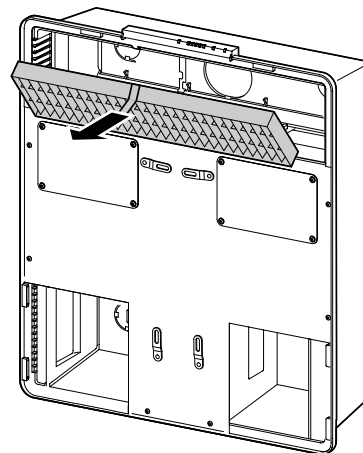

Remove the supply air filter

22

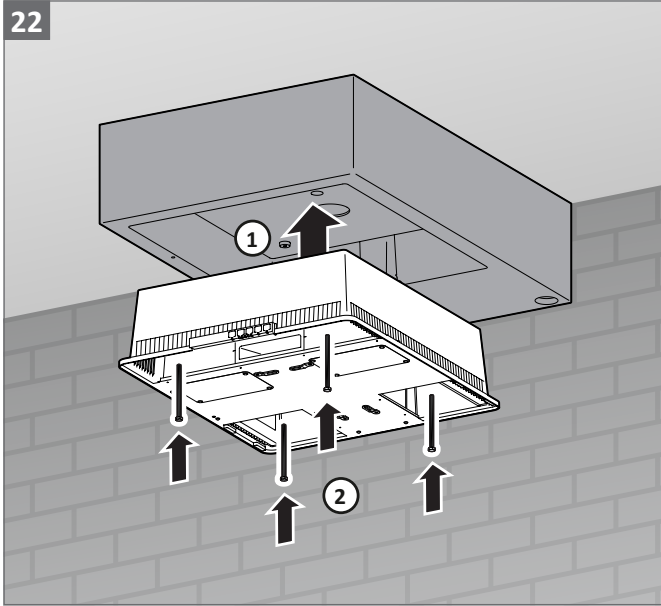

Insert AEROVITAL ambience smart DM in assembly case and fix with 4 M6 x 90 hexagon screws

23

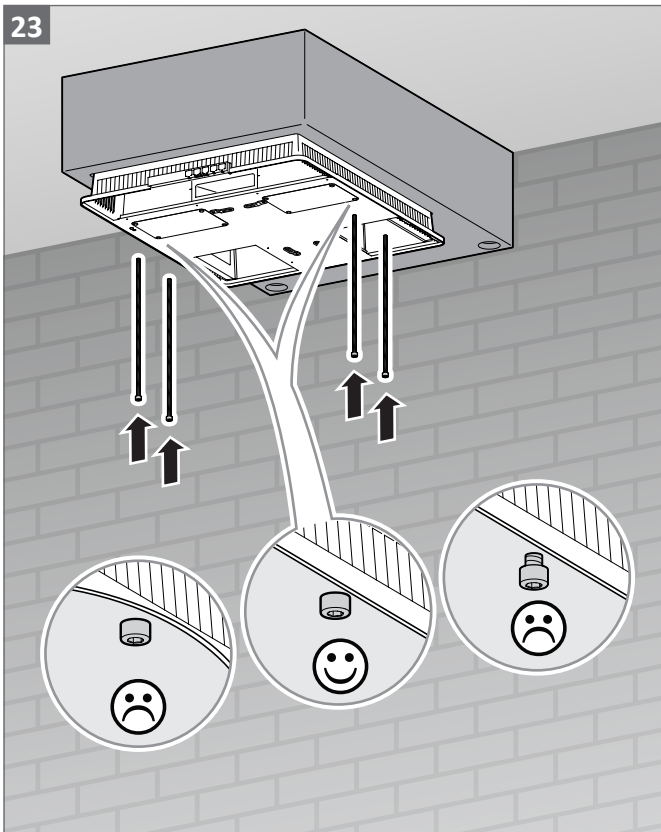

Fix AEROVITAL ambience smart DM with 4 M6 x 250 hexagon screws



Tighten the screws until they are in contact with the cover plate.

Do not overtighten the screws, otherwise the cover plate will be misshapen.

⚠ DANGER
Exposed electrical components
Risk of fatal injury from electric shock or fire

- Make sure that the power supply has been switched off prior to installation.
- All-pole safety isolation is required if the customer is routing the mains cable.

24

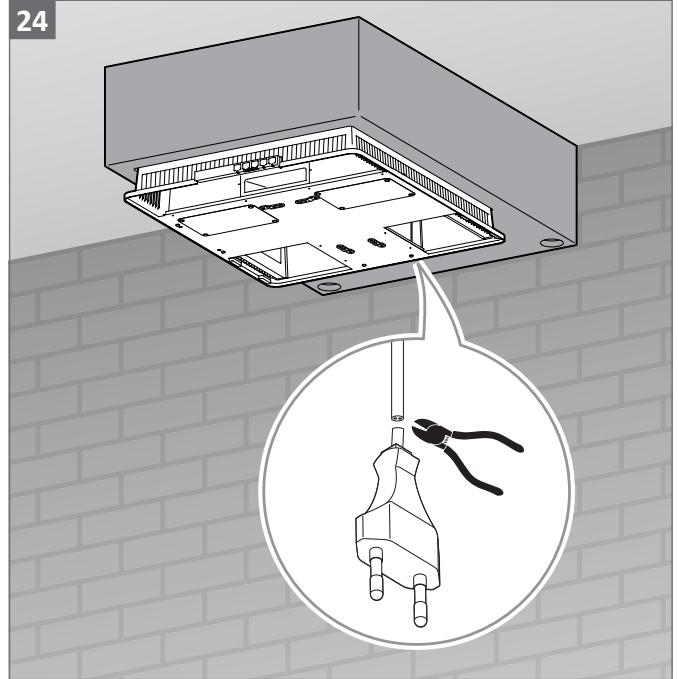

Cut off power plug AEROVITAL ambience smart DM

25

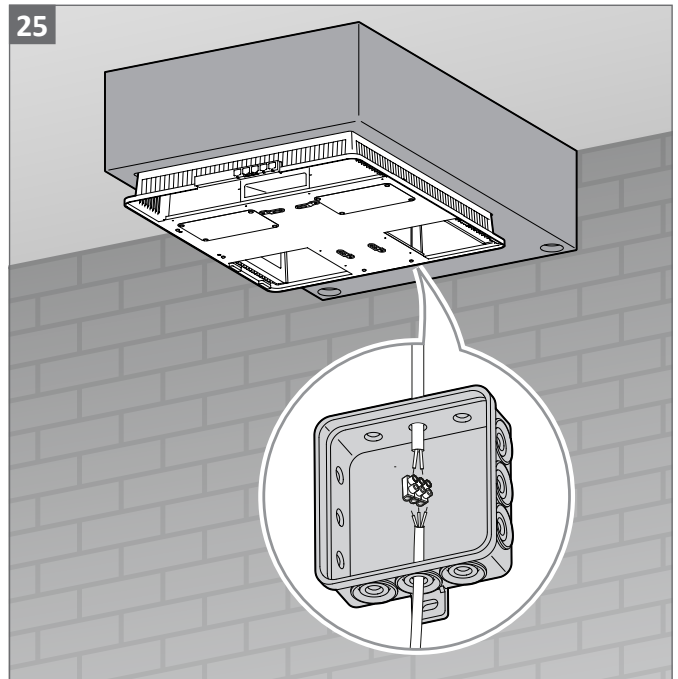

Connect device to power grid and push cable junction box into assembly case

26

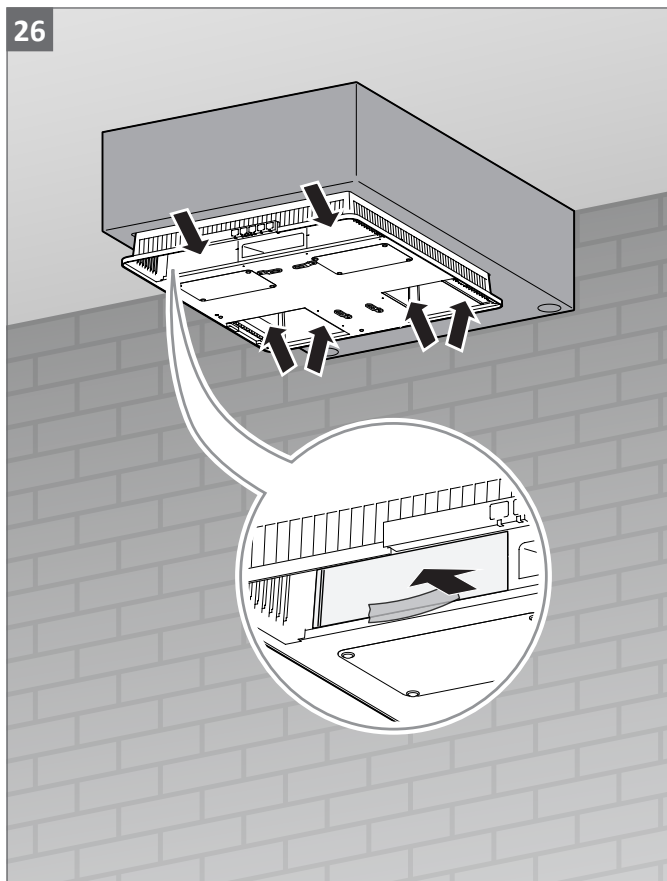

Loosen transport adhesive tape (6 strips)

27

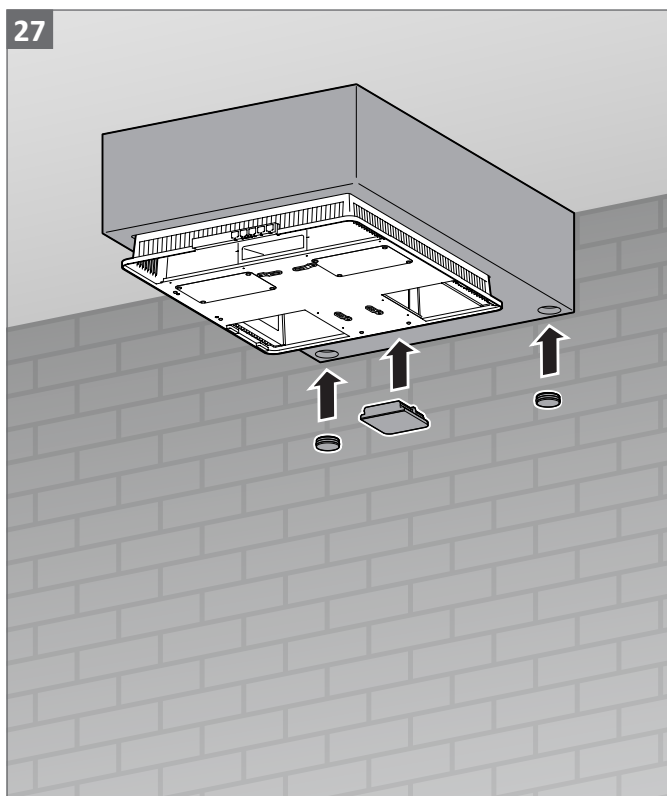

Clamp plugs onto fixing holes and clamp cover onto electrical connection

WARNING

High weight of the ceramic heat accumulator

Risk of injury due to ceramic heat accumulator falling out

WARNING



- Ensure that the ceramic heat accumulator does not fall down.
- Proceed with caution.

28

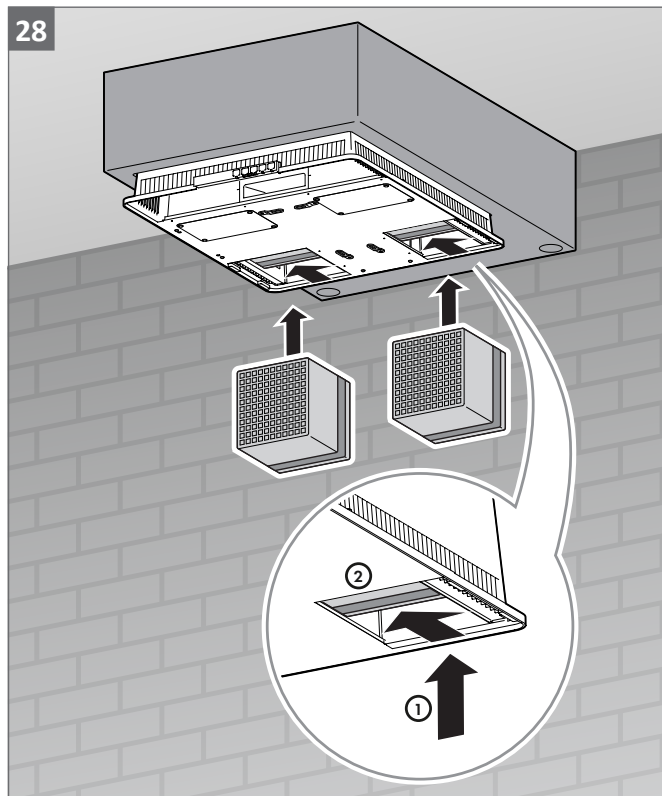

Position the ceramic heat accumulator in the centre and press into the casing until it engages

29

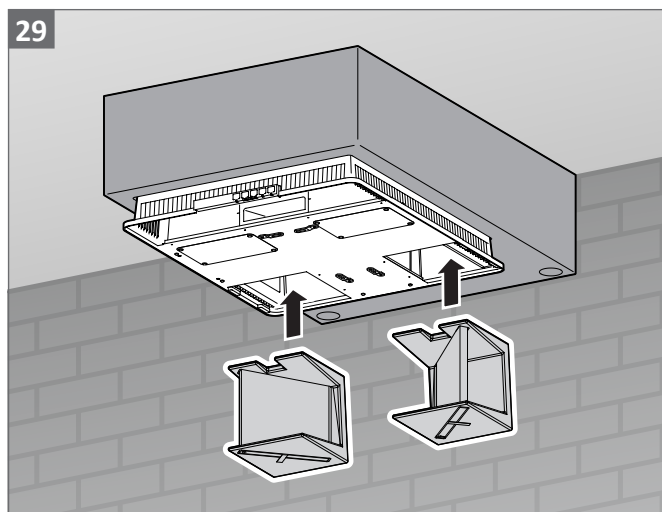

Position the exhaust air filter and filter bracket in the centre

30

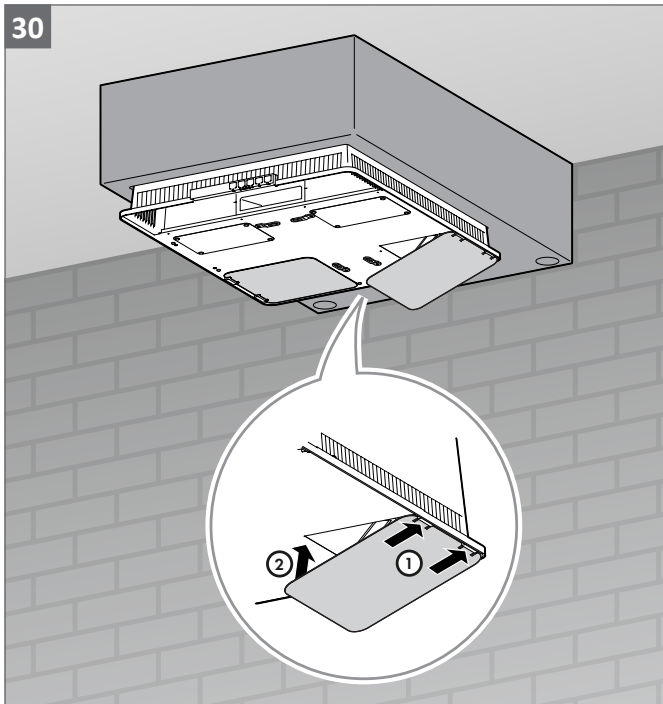

Position the bottom cover plate and press into place

⚠ WARNING

Strong gravitational pull of the magnets

If you are not careful, your fingers or hand could be caught between two plates. This could lead to crushing and bruises.

- Proceed with caution.

31

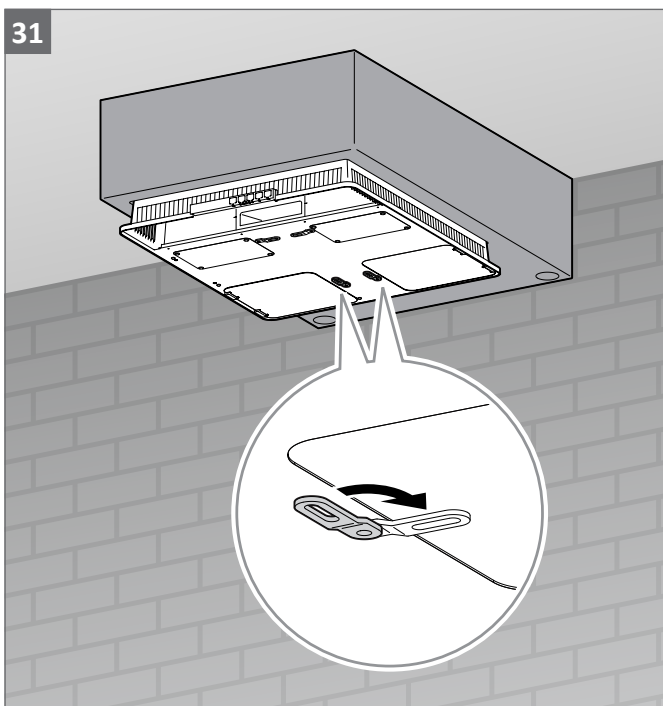

Fix the bottom cover plate with fixing brackets

32

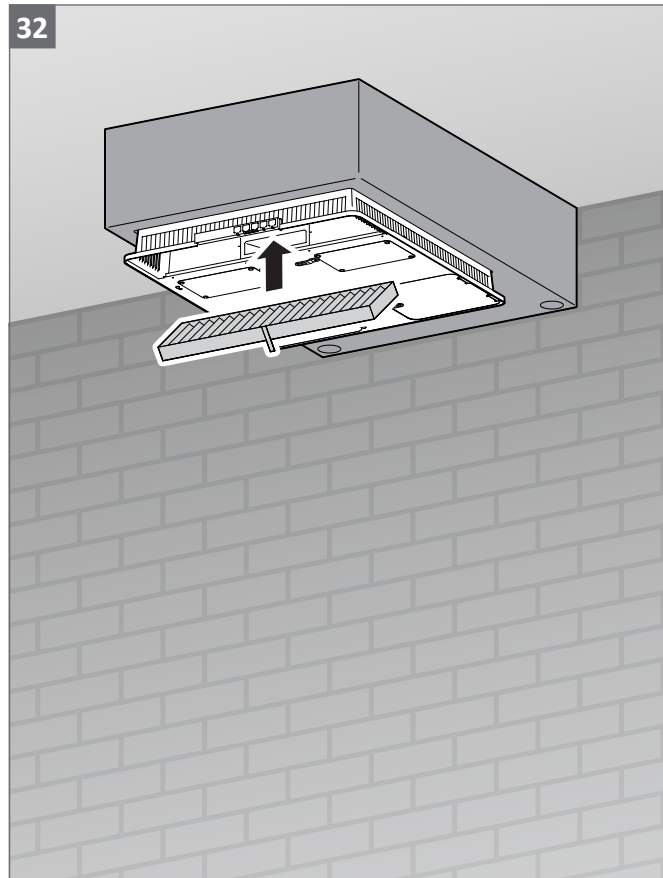

Insert the supply air filter

33

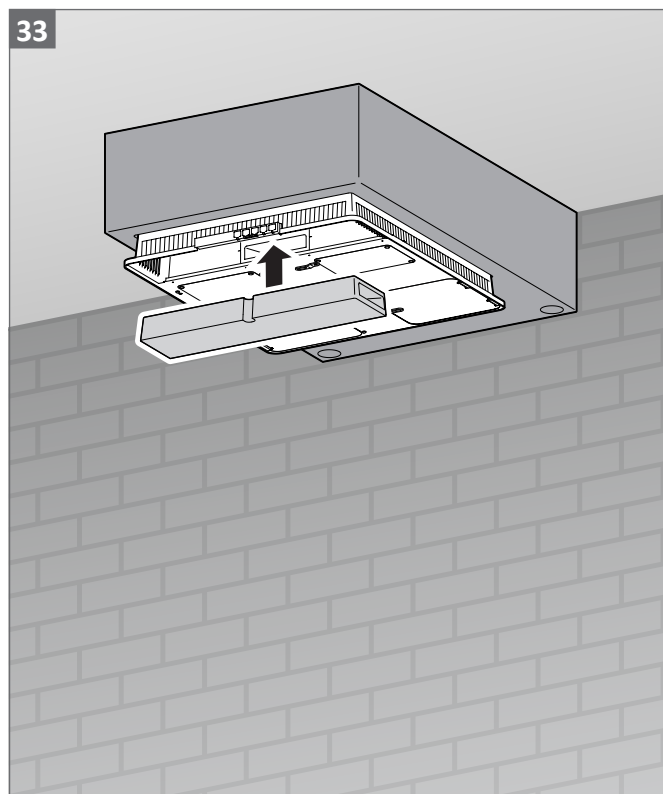

Position the muffler in the centre

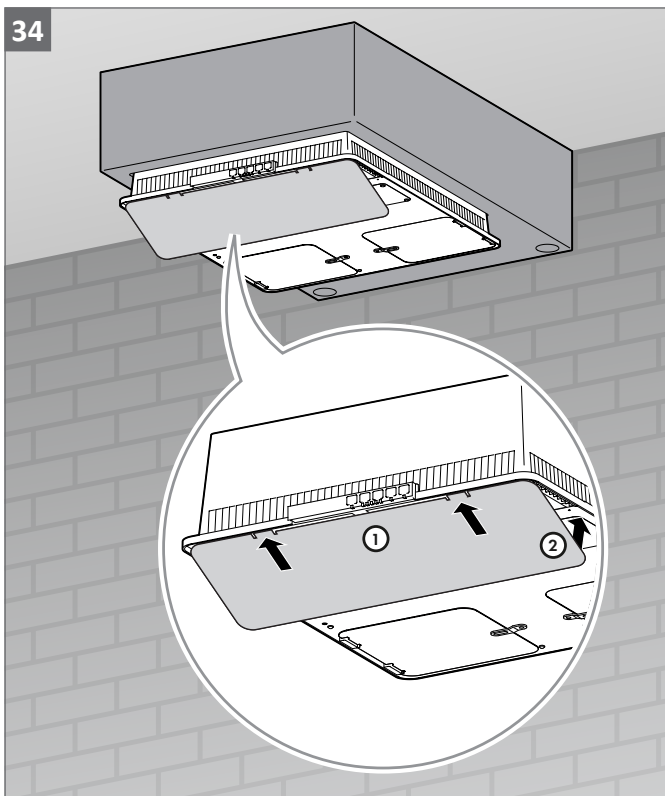

Position the top cover plate and press into place

⚠ WARNING

Strong gravitational pull of the magnets

If you are not careful, your fingers or hand could be caught between two plates. This could lead to crushing and bruises.

- Proceed with caution.

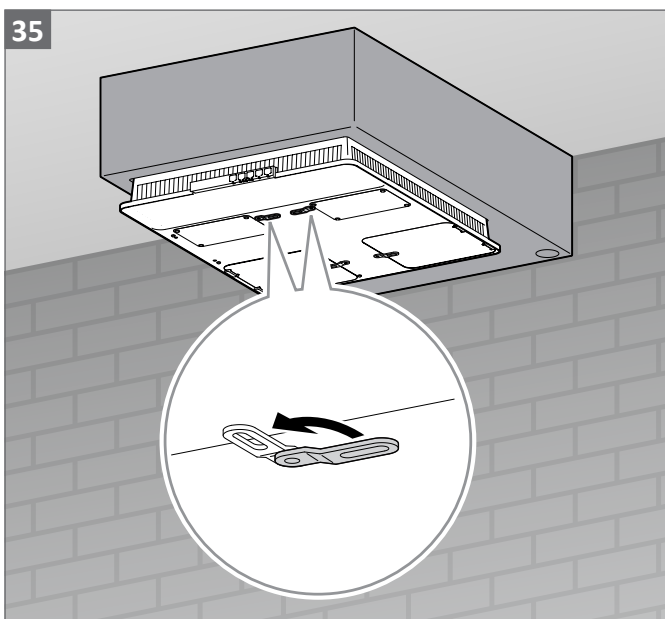

Fix the top cover plate

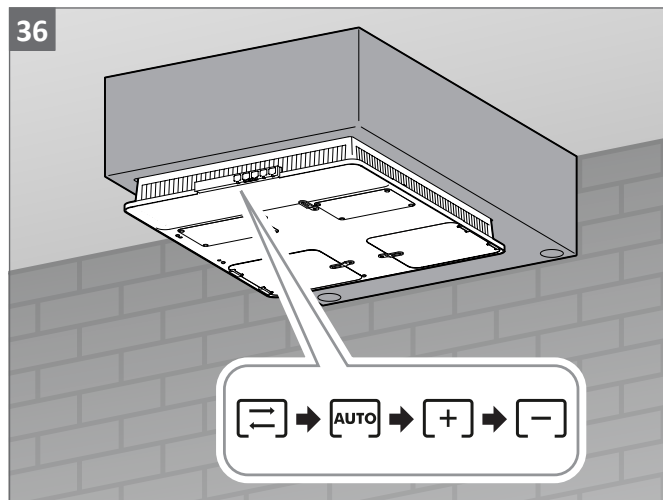

Switch on the current and perform a unit test run. Enter the illustrated key combination to do this

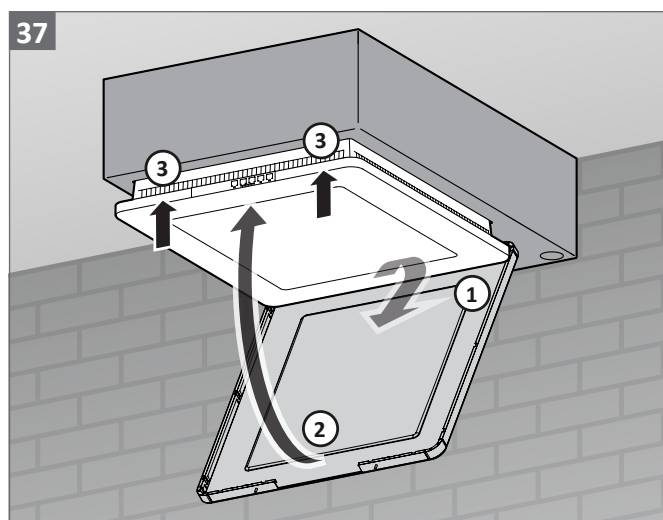

Close the casing cover

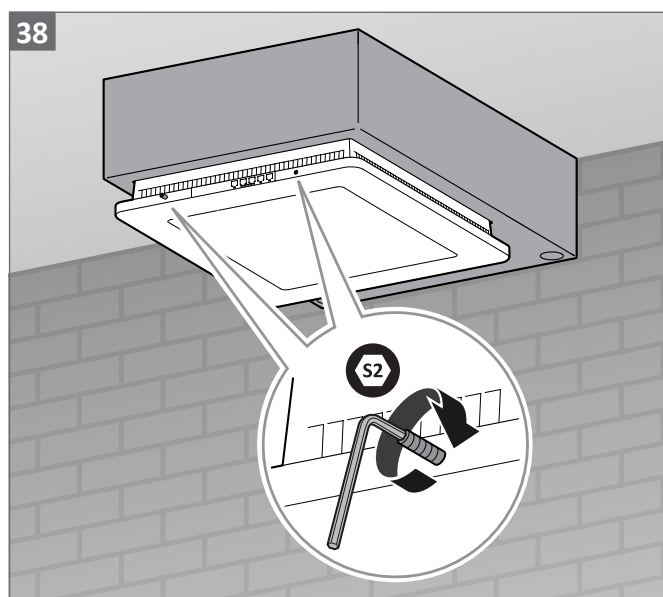

Tighten the grub screw

7 Technical specifications

AEROVITAL ambience smart DM	
Inherent noise (measured according to DIN EN ISO 3741 with room insulation of 8 dB)	Level 1 $L_{PA} = 20$ dB (A) Level 2 $L_{PA} = 22$ dB (A) Level 3 $L_{PA} = 25$ dB (A) Level 4 $L_{PA} = 30$ dB (A) Level 5 $L_{PA} = 31$ dB (A)
Air throughput	Level 1 24 m ³ /h Level 2 28 m ³ /h Level 3 41 m ³ /h Level 4 51 m ³ /h Level 5 56 m ³ /h
Power consumption (normal operating mode)	Level 1 6 W Level 2 6 W Level 3 8 W Level 4 11 W Level 5 12 W
Heat recovery efficiency (in accordance with DiBT)	up to 85 %
Sound absorption (in accordance with DIN EN 10140-2)	$D_{n,e,w} = 54$ dB
Sound absorption thanks to sound absorption pipe (measured in accordance with DIN EN 10140-2)	$D_{n,e,w} = 58$ dB
Electrical connection	230 V AC / 0.06 A
Protection class	II
Weight	24 kg
Fresh air filters (supply air and exhaust air filters)	Filter grade ePM10 50%
Admissible utilisation temperature	-15 °C to +40 °C

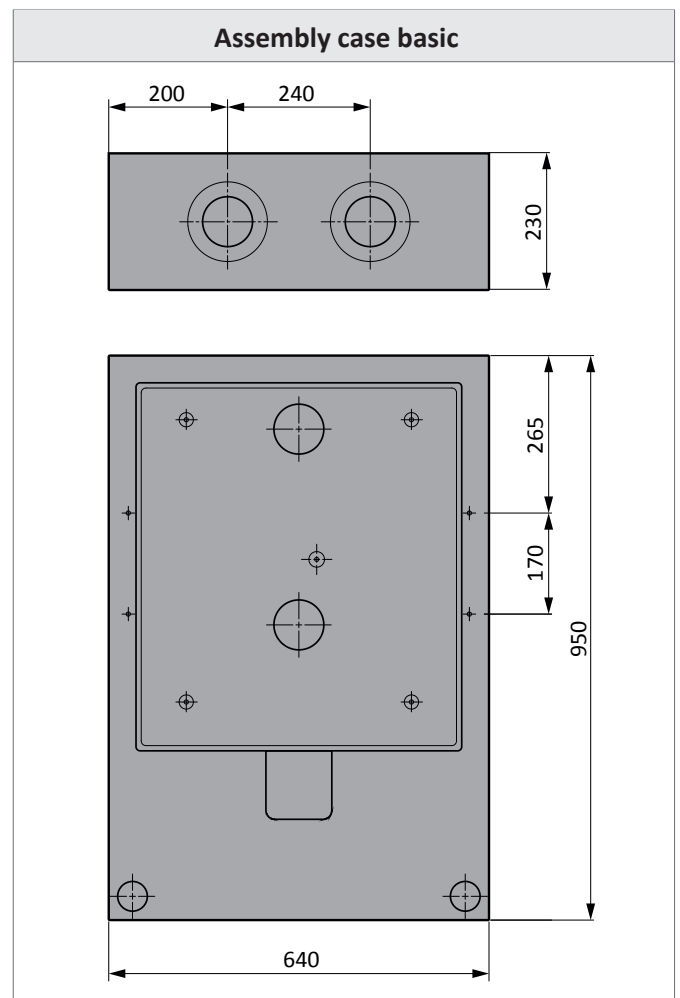
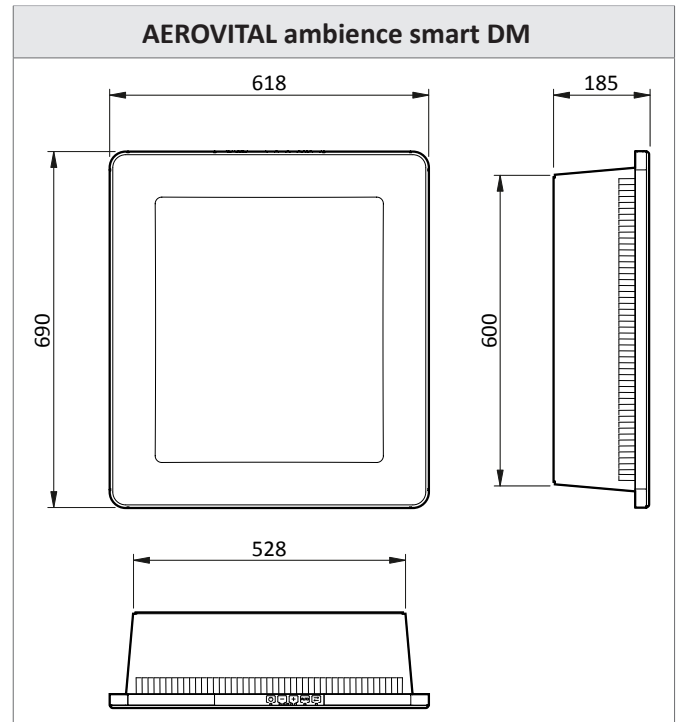

www.siegenia.com



SIEGENIA[®]
brings spaces to life